

Shape A, Cylindrical

Ordering example: A10010210305

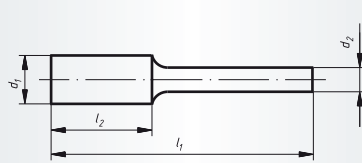

Packing unit:

1 pc. per type

Further dimensions, cuts and shank lengths on request.

regrind service, please enquire

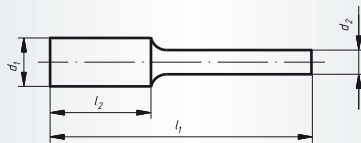
Description	Cut	similar DIN 8033	d ₁ mm	l ₂ mm	d ₂ mm	l ₁ mm	Product-Number	recommended for								New burrs	
								1	2	3	4	5	6	7	8		
HFA 0210.03	Z5	ZYA 0210	2	10	3	40	A10010210305	1	2	3	4			7			■
HFA 0313.03	Z3	ZYA 0313	3	13	3	40	A10010313303	1	2	3	4			7			■
HFA 0313.03	Z4	ZYA 0313	3	13	3	40	A10010313304		2	3	4			7	8		■
HFA 0313.03	Z5	ZYA 0313	3	13	3	40	A10010313305	1	2	3	4			7			■
HFA 0313.03	Z7	ZYA 0313	3	13	3	40	A10010313308	1	2	3		5		7			■
HFA 0413.06	Z3	ZYA 0413	4	13	6	50	A10010413603	1	2	3	4			7			■
HFA 0413.06	Z7	ZYA 0413	4	13	6	50	A10010413608	1	2	3		5		7			■
HFA 0607.03	Z5	ZYA 0607	6	7	3	37	A10010607305	1	2	3	4			7			■
HFA 0613.03	Z5	ZYA 0613	6	13	3	43	A10010613305	1	2	3	4			7			■
HFA 0613.03	Z7	ZYA 0613	6	13	3	43	A10010613308	1	2	3		5		7			■
HFA 0616.06	Z2	ZYA 0616	6	16	6	50	A10010616602	1				5	6		8		■
HFA 0616.06	Z3	ZYA 0616	6	16	6	50	A10010616603	1	2	3	4			7			■
HFA 0616.06	Z4	ZYA 0616	6	16	6	50	A10010616604		2	3	4			7	8		■
HFA 0616.06	Z5	ZYA 0616	6	16	6	50	A10010616605	1	2	3	4			7			■
HFA 0616.06	Z7	ZYA 0616	6	16	6	50	A10010616608	1	2	3		5		7			■
HFA 0616.06	Z9	ZYA 0616	6	16	6	50	A10010616609						6		8		■
HFA 0820.06	Z3	ZYA 0820	8	20	6	60	A10010820603	1	2	3	4			7			■
HFA 0820.06	Z4	ZYA 0820	8	20	6	60	A10010820604		2	3	4			7	8		■
HFA 0820.06	Z5	ZYA 0820	8	20	6	60	A10010820605	1	2	3	4			7			■
HFA 0820.06	Z7	ZYA 0820	8	20	6	60	A10010820608	1	2	3		5		7			■
HFA 1013.06	Z3	ZYA 1013	10	13	6	53	A10011013603	1	2	3	4			7			■
HFA 1013.06	Z7	ZYA 1013	10	13	6	53	A10011013608	1	2	3		5		7			■
HFA 1013.08	Z3	ZYA 1013	10	13	8	53	A10011013803	1	2	3	4			7			■
HFA 1020.06	Z3	ZYA 1020	10	20	6	60	A10011020603	1	2	3	4			7			■
HFA 1020.06	Z4	ZYA 1020	10	20	6	60	A10011020604		2	3	4			7	8		■
HFA 1020.06	Z7	ZYA 1020	10	20	6	60	A10011020608	1	2	3		5		7			■
HFA 1020.08	Z3	ZYA 1020	10	20	8	60	A10011020803	1	2	3	4			7			■
HFA 1025.06	Z4	ZYA 1025	10	25	6	65	A10011025604		2	3	4			7	8		■
HFA 1025.06	Z7	ZYA 1025	10	25	6	65	A10011025608	1	2	3		5		7			■
HFA 1025.08	Z3	ZYA 1025	10	25	8	65	A10011025803	1	2	3	4			7			■
HFA 1225.06	Z3	ZYA 1225	12	25	6	65	A10011225603	1	2	3	4			7			■
HFA 1225.06	Z4	ZYA 1225	12	25	6	65	A10011225604		2	3	4			7	8		■
HFA 1225.06	Z5	ZYA 1225	12	25	6	65	A10011225605	1	2	3	4			7			■
HFA 1225.06	Z7	ZYA 1225	12	25	6	65	A10011225608	1	2	3		5		7			■
HFA 1225.06	Z9	ZYA 1225	12	25	6	65	A10011225609						6		8		■
HFA 1225.08	Z3	ZYA 1225	12	25	8	65	A10011225803	1	2	3	4			7			■
HFA 1225.08	Z4	ZYA 1225	12	25	8	65	A10011225804		2	3	4			7	8		■
HFA 1225.08	Z9	ZYA 1225	12	25	8	65	A10011225809						6		8		■

Shape A, Cylindrical
Ordering example:A10011625603

Packing unit:

1 pc. per type

Further dimensions, cuts and shank lengths on request.

regrind service, please enquire

Description	Cut	similar DIN 8033	d ₁ mm	l ₂ mm	d ₂ mm	l ₁ mm	Product-Number	recommended for	New burrs
HFA 1625.06	Z3	ZYA 1625	16	25	6	65	A10011625603		
HFA 1625.06	Z7	ZYA 1625	16	25	6	65	A10011625608		
HFA 1625.06	Z9	ZYA 1625	16	25	6	65	A10011625609		
HFA 1625.08	Z9	ZYA 1625	16	25	8	65	A10011625809		

Material classification

- 1 STEELS AND CAST STEELS**
Rm up to 800 N/mm²
 - common structural steels
 - free cutting steels
 - case hardened steels
 - fine grained structural steels
 - extruded steels
 - toughened structural steels
 - boiler plate
 - nitrided steels
 - cast steels
 - heat treated steels
 - heat resistant structural steels
- 2 ALLOYED, TEMPERED STEELS**
Rm 800 up to 1200 N/mm²
 - case hardened steels
 - spring steels
 - fine grained structural steels
 - nitrided steels
 - heat treated steels
 - wear resistant steels
 - bearing steels
- 3 TOOL STEELS** Rm up to 1300 N/mm²
 - 60 - 65 HRC
 - high-speed steels
 - non-alloyed tool steels
 - cold working tool steels
 - hot working tool steels
- 4 RUST, ACID AND HEAT RESISTANT STEELS AND CAST STEELS**
 - austenitic
 - ferritic
 - ferritic-austenitic
 - heat-resistant
 - martensitic
 - stainless, sulphurized

- 5 CAST IRON**
- 6 ALUMINIUM, MAGNESIUM AND COPPER ALLOYS**
 - over 300 HB
 - 200-300 HB
 - up to 200 HB
 - over 15% Si
 - 10-15% Si
 - 0,5-10% Si
 - below 0,5% Si
- 7 TITANIUM AND NICKEL ALLOYS**
 - Rm 900 up to 1500 N/mm²
 - Rm up to 900 N/mm²
- 8 PLASTICS, WOOD, RUBBER**
- 9 GLASS / CARBIDES**
- 10 STONE / TILES / GAS CEMENT**
- 11 CONCRETE / REINFORCED CONCRETE**
- 12 CERAMIC / FLOOR TILES**
- 13 MARBLE**
- 14 GRANITE**
- 15 FRESHLY POURED CONCRETE**
- 16 ASPHALT**

- best suitable
- suitable
- delivery ex-stock
- ▲ delivery on request
- ⊞ regrind service, please enquire

Safety Symbols

			
Wear eye protection	Wear hearing protection	Wear a respirator	Read the instructions
			
Wear gloves	Only permitted with a back-up pad		
			
Not permitted for wet grinding	Not permitted for face grinding	Do not use if damaged	Do not use for freehand cutting